

FOREST QUILTING

www.forestquilting.com

SALT SHAKER HOUSE

December 2004

Patrice Trnka Adams



Salt Shaker House Wallhanging

17 by 17 inches

4 - 6 inch house blocks

Sashing = 1/2 inch

Border (inside) = 1 inch

Border (outside) = 1 inch

Binding = 1/4 inch

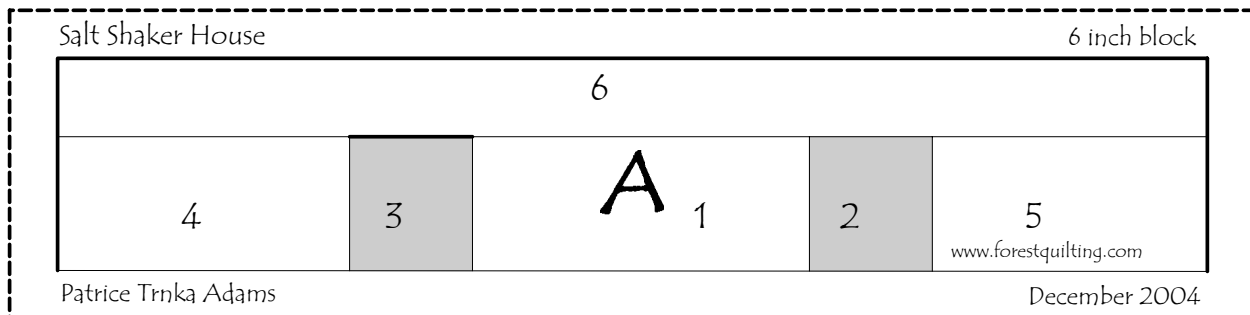
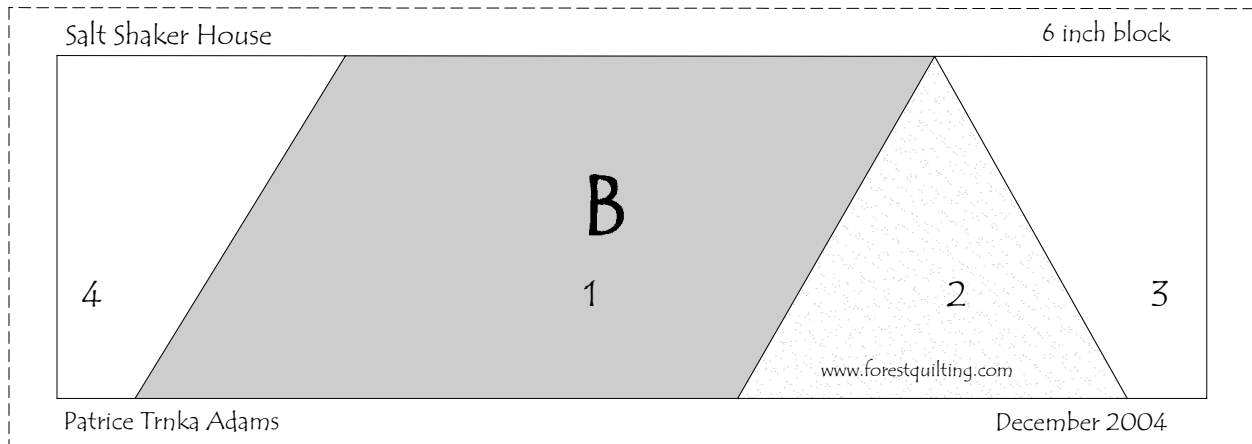
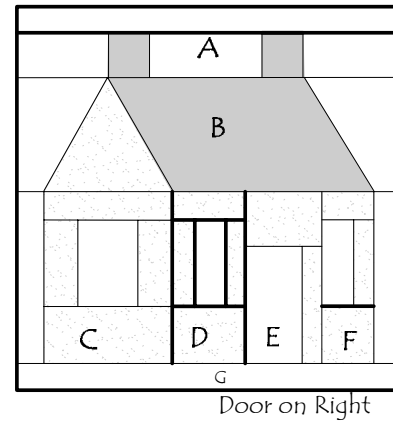
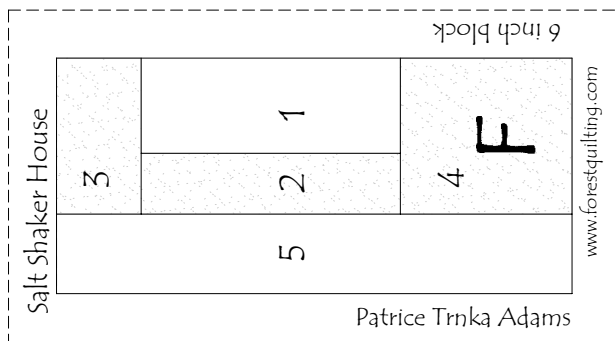

FOREST QUILTING

www.forestquilting.com

SALT SHAKER HOUSE

December 2004
Patrice Trnka Adams

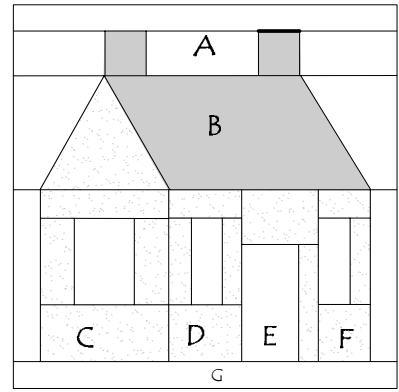

Door on Right

Salt Shaker House 6 inch block

www.forestquilting.com

Patrice Trnka Adams December 2004

Salt Shaker House

6 inch block

www.forestquilting.com

Patrice Trnka Adams December 2004

Salt Shaker House

6 inch block

www.forestquilting.com

Patrice Trnka Adams December 2004

Salt Shaker House 6 inch block

www.forestquilting.com

Patrice Trnka Adams December 2004

FOREST QUILTING

www.forestquilting.com

SALT SHAKER HOUSE

December 2004

Patrice Trnka Adams

DOOR ON LEFT



Salt Shaker House Wallhanging
17 by 17 inches

- 4 - 6 inch house blocks
- Sashing = 1/2 inch
- Border (inside) = 1 inch
- Border (outside) = 1 inch
- Binding = 1/4 inch

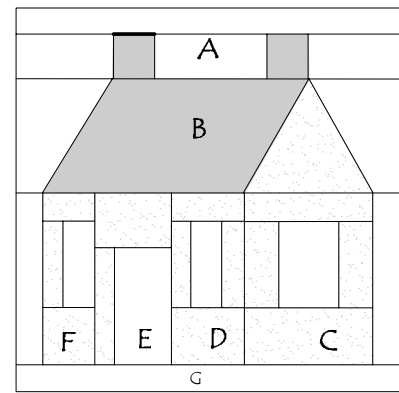
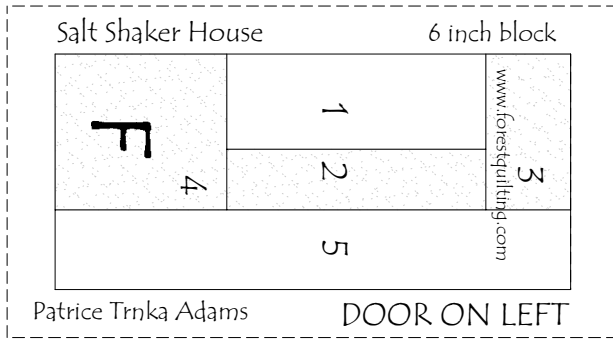

Door on Left

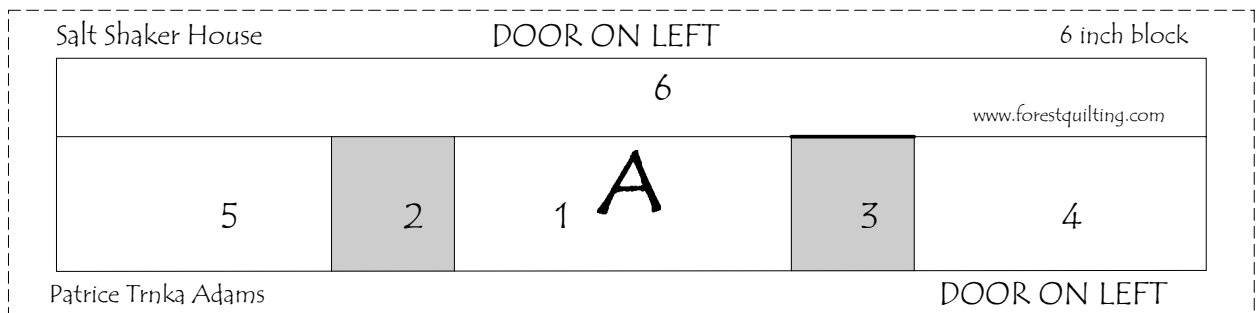
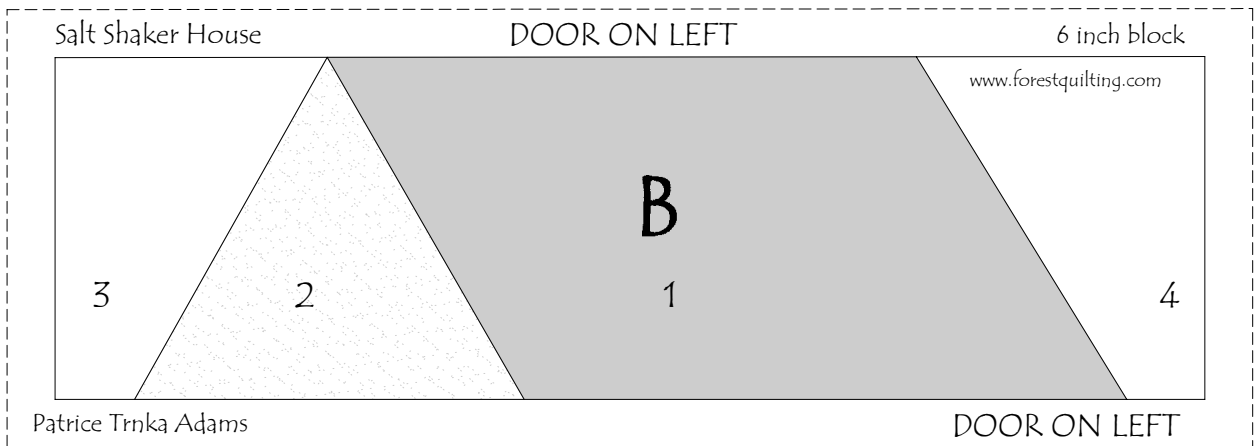

FOREST QUILTING

www.forestquilting.com

SALT SHAKER HOUSE

December 2004

Patrice Trnka Adams

DOOR ON LEFT

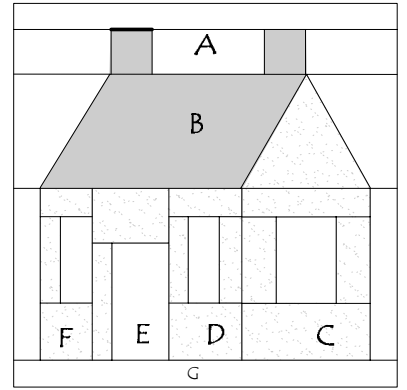

Door on Left

