

# FOREST QUILTING

www.forestquilting.com

## Simple House

April 2007

Patrice Trnka Adams

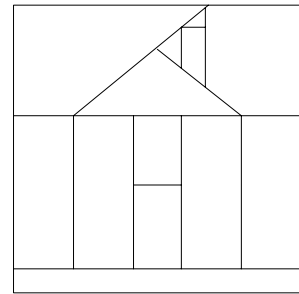

Wallhanging - 18.5 inch square

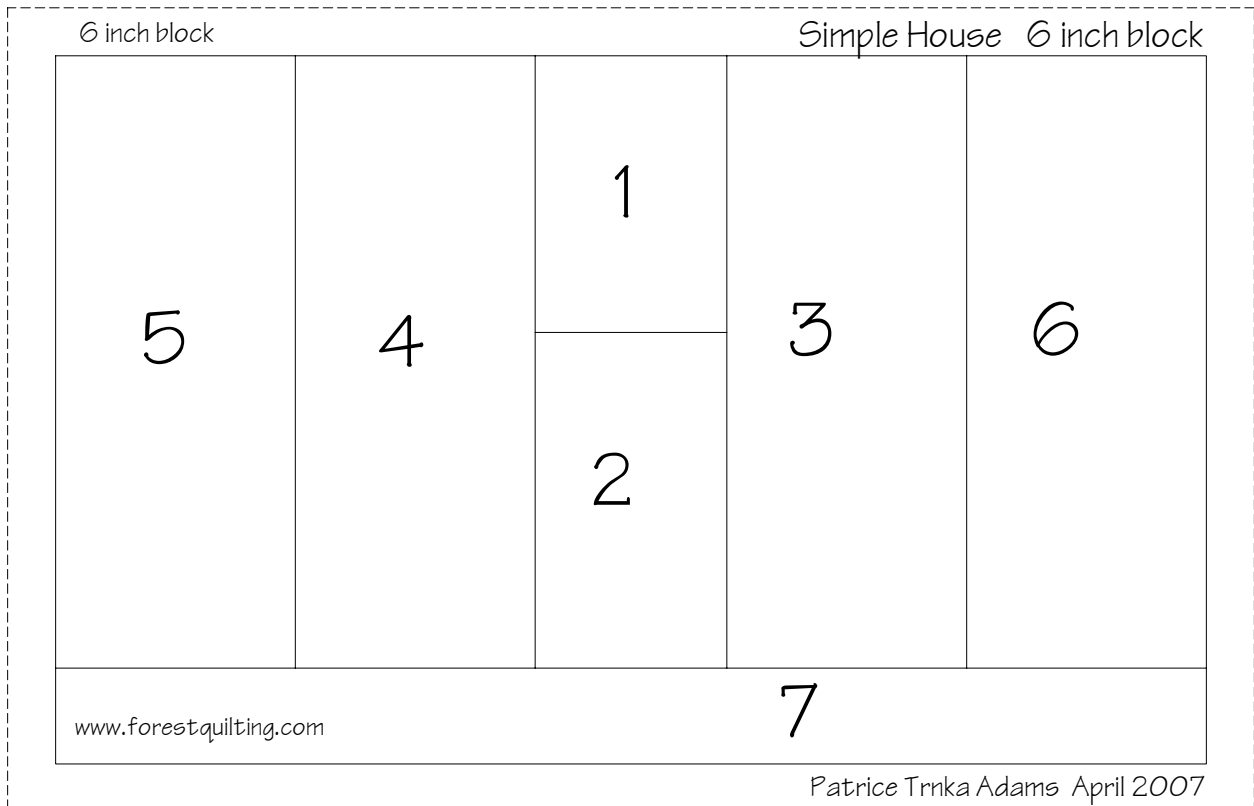
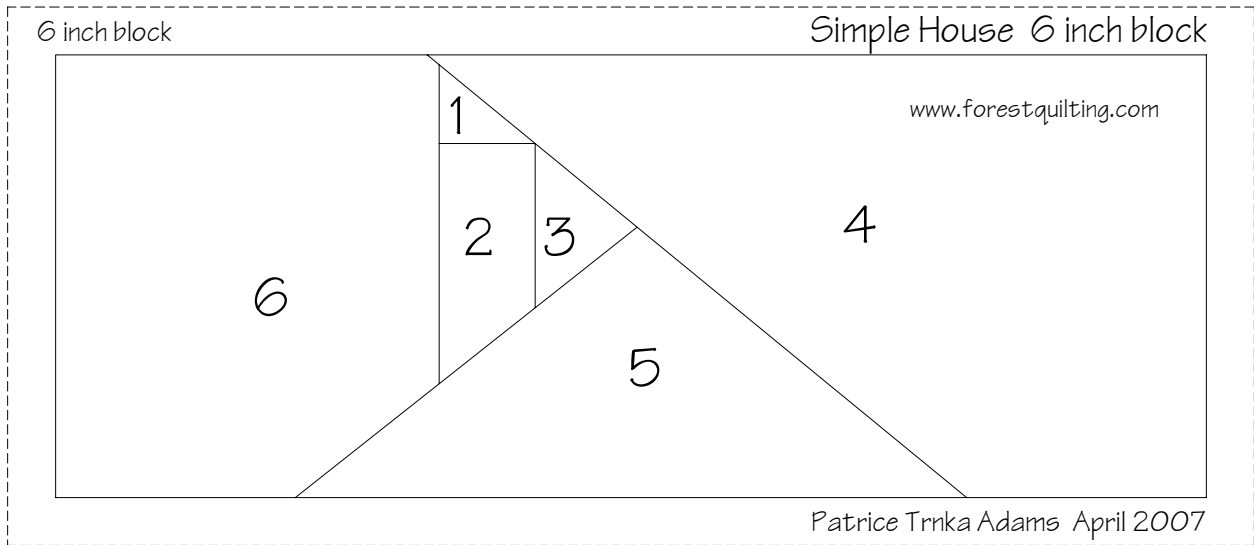

# FOREST QUILTING

www.forestquilting.com

## Simple House

April 2007  
Patrice Trnka Adams

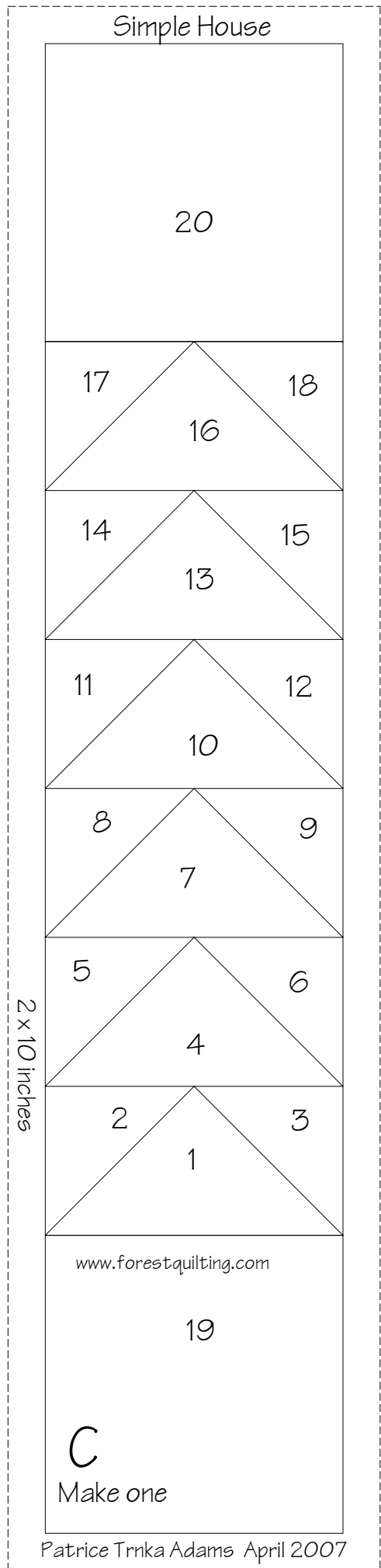
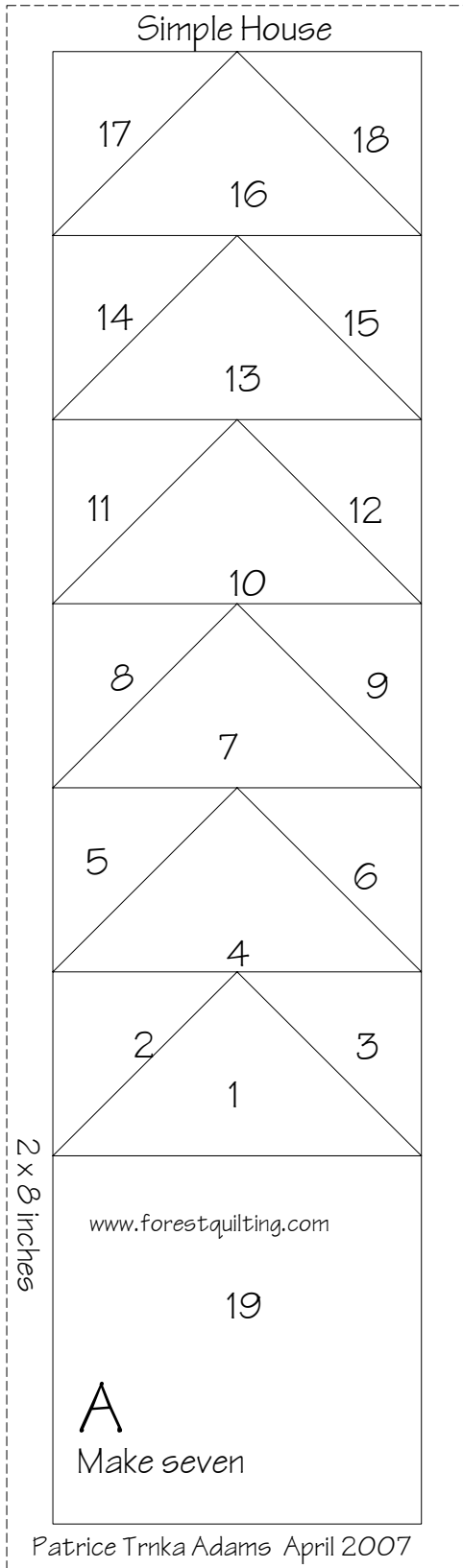
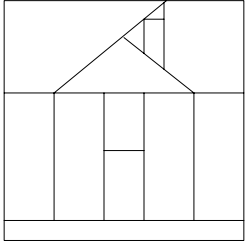

# FOREST QUILTING

www.forestquilting.com

## Simple House

April 2007

Patrice Trnka Adams



Simple House  
Wallhanging  
18.5 inches by 18.5 inches  
Six inch Simple House Blocks

6 inch block

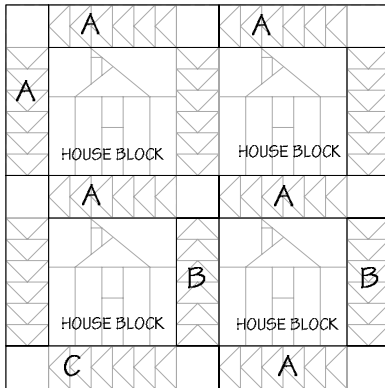
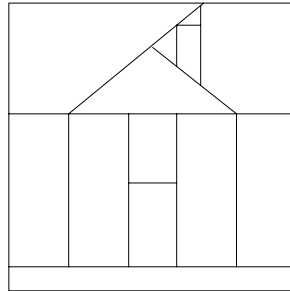

Add quarter inch binding

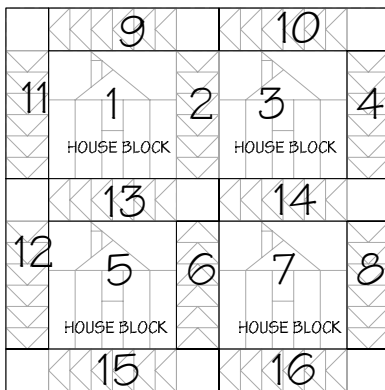

Add quarter inch binding

Sew 1, 2, 3, & 4 together.  
Sew 5, 6, 7 & 8 together.  
Sew 9 & 10 together.  
Sew 11 & 12 together.  
Sew 13 & 14 together.  
Sew 15 & 16 together.  
Sew Pieces (1,2,3,4), (9,10), (13,14) & (5,6,7,8)  
together as illustrated.  
Add Piece (11, 12).  
Complete by adding Piece (15, 16)

